

AIRCRAFT PARKING CHART
APRON - ICAO

AD ELEV 1017'

15°57'33"S
5°38'45"W

ST HELENA TWR 118.2
APP 119.5

ST HELENA
ST HELENA AIRPORT

AMENDMENTS

DATE	DESCRIPTION
28-04-2016	FIRST RELEASE
01-04-2016	SECOND RELEASE
26-05-2016	THIRD RELEASE
30-03-2017	PAGE NUMBER AND FREQUENCY

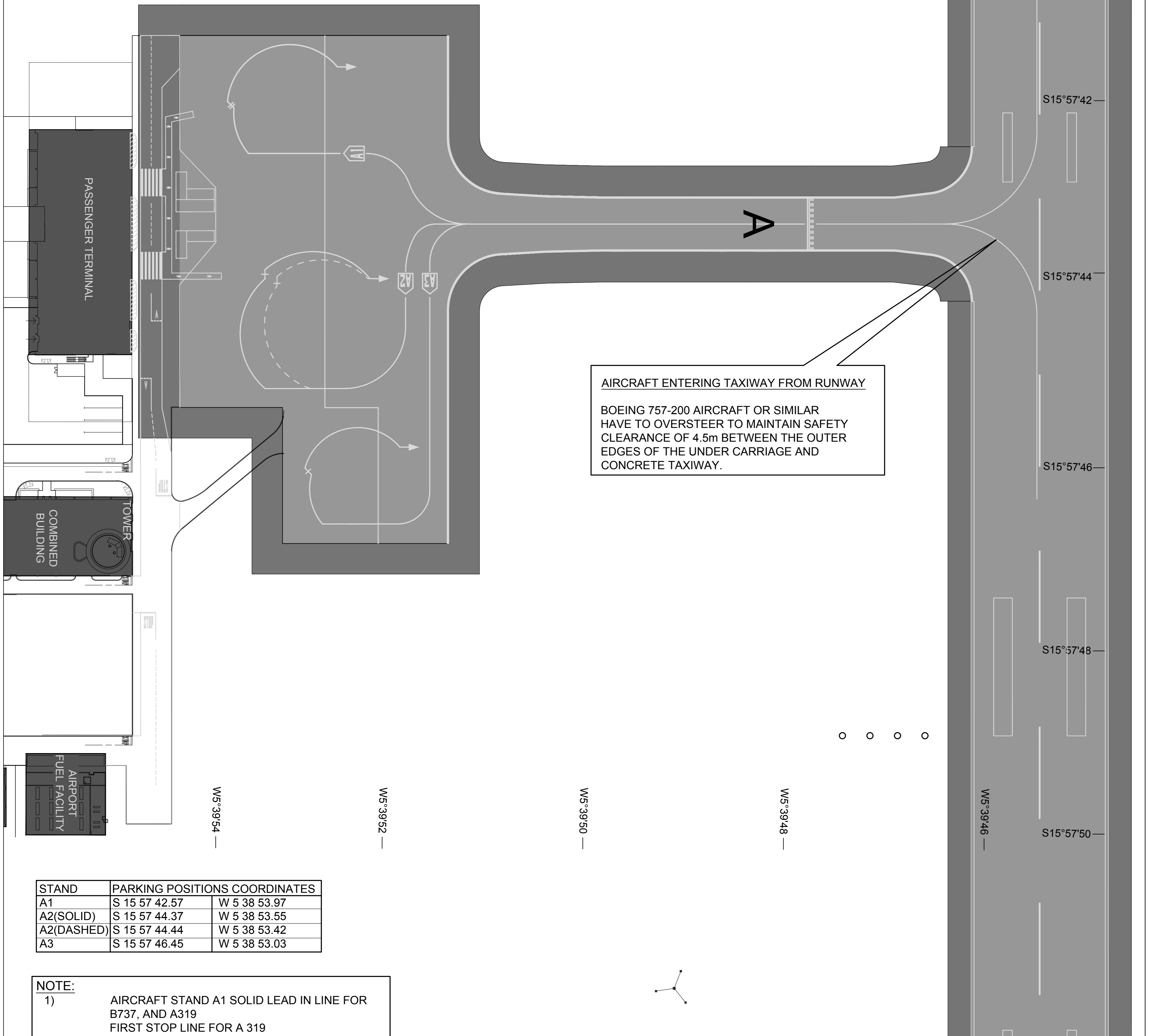
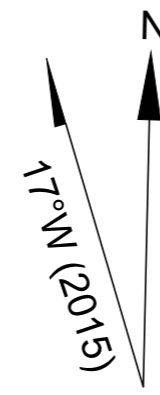

AIRCRAFT ENTERING TAXIWAY FROM RUNWAY
BOEING 757-200 AIRCRAFT OR SIMILAR
HAVE TO OVERSTEER TO MAINTAIN SAFETY
CLEARANCE OF 4.5m BETWEEN THE OUTER
EDGES OF THE UNDER CARRIAGE AND
CONCRETE TAXIWAY.

STAND	PARKING POSITIONS COORDINATES	
A1	S 15 57 42.57	W 5 38 53.97
A2(SOLID)	S 15 57 44.37	W 5 38 53.55
A2(DASHED)	S 15 57 44.44	W 5 38 53.42
A3	S 15 57 46.45	W 5 38 53.03

NOTE:

- 1) AIRCRAFT STAND A1 SOLID LEAD IN LINE FOR B737, AND A319
FIRST STOP LINE FOR A 319
SECOND STOP LINE FOR 737
- 2) AIRCRAFT STAND A2 SOLID LEAD IN LINE FOR B737, B757 AND A319
- 3) AIRCRAFT STAND A2 DASHED LEAD IN LINE FOR LOCKHEED L100 C130 ONLY.
- 4) AIRCRAFT STAND A3 SOLID LEAD IN LINE FOR B TYPE AIRCRAFT ONLY.

